

# INGRASSATORI HYDRAULIC HYDRAULIC GREASE NIPPLES

## MATERIALE / MATERIAL

- 1 AISI INOX 303 INOX V2A   
 A1 AISI INOX 316 INOX V4A   
 O OTTONE NICHEL. NICKEL PL. BRASS   
 AZ ACCIAIO ZINCATO ZINC PLATED STEEL

### Art. 271



A	B	GAS	WW	SAE	NPT	C	CH	GRADI
6	M6x1					28	7	

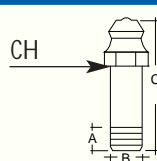

### Art. 273



### Art. 273 I



A	B	GAS	WW	SAE	NPT	C	CH	GRADI
5,5	M6x0,75		1/4	1/4		15	7	
5,5	M6x1					15	7	
5	M6x1					14	7	



### Art. 279



A	B	GAS	WW	SAE	NPT	C	CH	GRADI
5	M6x1					14	7	

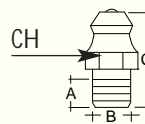

### Art. 278



### Art. 278 I



A	B	GAS	WW	SAE	NPT	C	CH	GRADI
6	M7x1					16	9	
6	M8x1					16	9	
6	M8x1,25		5/16			16	9	
5,5	M8x1					17	9	
5,5	M8x1,25					17	9	

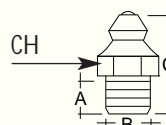

### Art. 270



### Art. 270 I



### Art. 270 NPT

A	B	GAS	WW	SAE	NPT	C	CH	GRADI
7	M6x1				1/8	17	11	
7	M10x1	1/8				18	11	
7	M10x1,25					18	11	
7	M10x1,5					18	11	
7	M10x1	1/8				18	11	



### Art. 270



### Art. 270 I



A	B	GAS	WW	SAE	NPT	C	CH	GRADI
8	M12x1,5					20	14	
8	M12x1,75	1/4				20	14	
7		1/4				19	14	

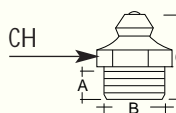

### Art. 272



### Art. 272 I



### Art. 272 NPT

A	B	GAS	WW	SAE	NPT	C	CH	GRADI
6	M6x1				1/8	26	11	45°
6	M8x1	1/8	1/4			26	11	45°
6	M8x1,25			1/4	28	26	11	45°
6	M10x1					26	11	45°
6	M10x1,25					26	11	45°
6	M10x1,5					26	11	45°
5	M6x1					25,5	11	45°
6	M10x1	1/8				25,5	11	45°

