

SPIE LIVELLO OLIO OIL LEVEL WINDOWS



Art. 722

Spia livello olio in alluminio. **Finestra in plexiglass**, indicatore a forma stellare bianca e guarnizione di tenuta in fibra.

Aluminium oil level window. Plexiglass window, coloured window surround and sealing ring.

Filetto	A	B	CH
Thread	A	B	CH
G 1/4	9	8	17
G 3/8	10	9	22
G 1/2	10	9	27
G 3/4	11	10	32
G 1"	12	10	41



Temperatura max. plexiglass 70° C - Pressione esercizio max. 3,5 BAR
Max. temperature plexiglass 70° C - Max. work pressure 3,5 BAR

Art. 723

Spia livello olio in alluminio. **Finestra in vetro**, indicatore a forma stellare bianca e guarnizione di tenuta in fibra.

Aluminium oil level window. Glass window, coloured window surround and sealing ring.

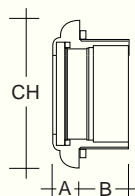

Filetto	A	B	CH
Thread	A	B	CH
G 3/8	8	8	22
G 1/2	8	9	27
G 3/4	10	10	32
G 1"	10	14	41
G 1-1/4	10	14	50
G 1-1/2	10	14	55
G 2"	9	14	70



Temperatura max. vetro 130° C - Pressione esercizio max. 4 BAR
Max. temperature glass 130° C - Max. work pressure 4 BAR

A richiesta filettature metriche
On request metric threads

Art. 720

Spia livello olio in resina poliammidica resistente ad agenti chimici, oli, benzine e solventi.

Polyamide oil level window resistant to chemical agents, oils and solvents.

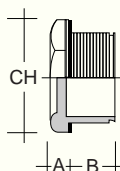

Filetto	A	B	CH
Thread	A	B	CH
G 1/4	7	8	17
G 3/8	6,5	10,5	18
G 1/2	8	11	24
G 3/4	8	12	30
G 1"	11	12	35
G 1-1/4	10	16	42
G 1-1/2	12	20	50
G 2"	12	20	64



Temperatura max. 90° C - Pressione max. 2 BAR - Guarnizione di tenuta in fibra
Max. temperature 90° C - Max. work pressure 2 BAR - Sealing ring

A&G Martinelli