

# INGRASSATORI ESAGONALI E TONDI

## BUTTON HEAD GREASE NIPPLES

### MATERIALE / MATERIAL

- 1 AISI INOX 303 INOX V2A    
 A1 AISI INOX 316 INOX V4A    
 0 OTTONE NICHEL. NICKEL PL. BRASS    
 AZ ACCIAIO ZINCATO ZINC PLATED STEEL

#### Art. T9

AZ

A	B	GAS	WW	L	C	CH	T
7	M10x1				55	15	Ø 15
<i>in 2 pezzi - in 2 pieces</i>							

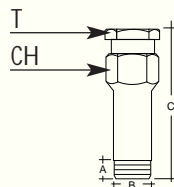

#### Art. T5A

AZ

A	B	GAS	WW	L	C	T
7	<i>in 2 pezzi a 90° su quadro mm 14 in 2 pieces at 90° on a 14 mm base</i>	1/8			21	Ø 15
7		1/4			21	Ø 15

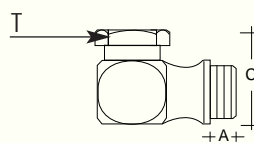

#### Art. M1

AZ

A	B	GAS	DIN	L	C	CH	T
8	M10x1	1/8	3404	4	19	17	Ø 16
8		1/4	3404	4	19	17	Ø 16

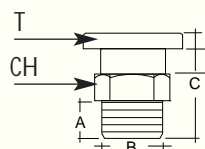

#### Art. 290

AZ

A	B	GAS	WW	L	C	CH	T
12		1/4			32	22	Ø 22
12		3/8			32	22	Ø 22
9	M16x1,5				24	22	Ø 22

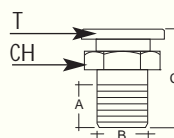

#### Art. MIN

AZ

A	B	GAS	WW	L	C	CH	T
13		1/4		<i>valvola riportata per added valve</i>	32	22	22

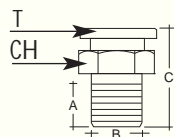

#### Art. MC

AZ

A	B	GAS	WW	L	C	CH	T
14		3/8		<i>valvola riportata per Caterpillar e Fiat added valve for Caterpillar and Fiat</i>	44	22	22

