

TESTINE PER INGRASSATORI HYDRAULIC HYDRAULIC CONNECTORS

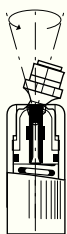

Art. 1000



Testina Excellent ABNOX di alta precisione a 4 griffes temprate e guarnizioni anti-olio.
Tenuta assoluta fino ad una inclinazione di 12°.
Attacco M10x1
Press. max. 400 BAR

*ABNOX Excellent heavy duty connector 4 jaws anti-oil washers.
Absolute tightness up to 12°.
Connection M10x1
Max. press. 400 BAR*

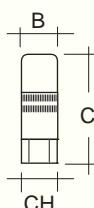

B	C	CH
Ø 16 mm	43 mm	15 mm

Materiale: acciaio zincato
Material: zinc plated steel

Art. 1010

Testina speciale ABNOX per chiusure idrauliche per pressione fino a 700 BAR.
Corpo in ETG 100, brunita.
Attacco M10x1

*ABNOX special connector for hydraulic clamping up to 700 bar pressure.
Sleeve bronzed steel ETG 100 .
Connection M10x1*

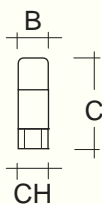

B	C	CH
Ø 15 mm	40 mm	14 mm

Art. 1020

Testina speciale ABNOX per olio tenuta assoluta fino ad una inclinazione di 12°.
Attacco 1/8 G.
Press. max. 400 BAR

*ABNOX special connector for oil absolute tightness up to 12°.
Connection 1/8 BSP.
Max. pressure 400 BAR.*

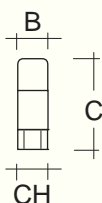

B	C	CH
Ø 16 mm	43 mm	15 mm

Materiale: acciaio zincato
Material: zinc plated steel

A&G Martinelli