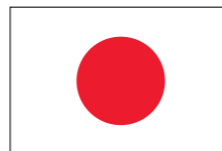

RUBINETTI E INNESTI RAPIDI GIGANTI GIAPPONESI BIG TYPE JAPAN QUICK COUPLINGS

Serie gigante Giapponesi DN 11 • Big type Japan series DN 11

DATI TECNICI

Fluidi compatibili: aria compressa
Corpo: acciaio temperato
Guarnizione: NBR
Temperatura di esercizio: -20 °C +80 °C
Pressione: max. 15 bar
Passaggio aria a 6 bar: lt./min. 3500
Valvola semi-automatica

Con blocco di sicurezza

TECHNICAL SPECIFICATIONS

Fluids: compressed air
Body: hardened steel
Seals: NBR
Operating temperature: -20 °C +80 °C
Max. pressure: 15 bar
Flow rate at 6 bar: lt./min. 3500
Semi-automatic valve

With safety lock

I dati tecnici e le quote non sono vincolanti • Drawings and specifications are not binding

Codice 6580 Rubinetto rapido maschio
Male quick coupler

A	L		Profilo
1/2	64	29	Gigante Japan
3/4	66	32	Gigante Japan

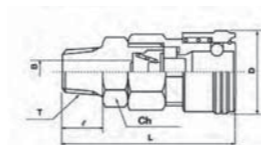
Codice 6581 Rubinetto rapido femmina
Female quick coupler

A	L		Profilo
1/2	58	29	Gigante Japan
3/4	61	35	Gigante Japan

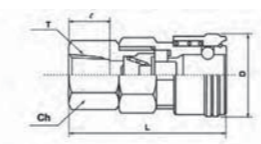
Codice 6582 Inneso rapido maschio
Male quick connection

A	L		Profilo
1/2	47	22	Gigante Japan
3/4	49	32	Gigante Japan

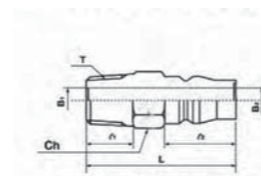
Codice 6585 Inneso rapido femmina
Female quick connection

A	L		Profilo
1/2	41	29	Gigante Japan
3/4	43	35	Gigante Japan

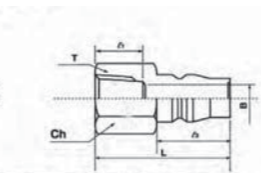

RACCORDI AUTOMATICI UNIVERSALI PER ACQUA QUICK COUPLINGS FOR WATER SYSTEM

DATI TECNICI

Applicazioni: circuiti acqua industriali, circuiti acqua raffreddamento, edilizia e irrigazione
Corpo: ottone nichelato
Valvola: materiale composito
Molla: acciaio inox
Temperatura di esercizio: -15 °C +60 °C
Pressione: max. 10 bar
Portata: 25 lt./min.
Filettatura: cilindrica ISO 228

TECHNICAL SPECIFICATIONS

Application: Industrial water lines, cooling circuits, constructions and agriculture
Body: nickel brass
Valve: composite material
Spring: stainless steel
Operating temperature: -15 °C +60 °C
Max. pressure: 10 bar
Flow rate: 25 lt./min.
Thread: parallel ISO 228

I dati tecnici e le quote non sono vincolanti • Drawings and specifications are not binding

Codice 6410 Rubinetto rapido femmina con valvola per acqua
Female quick coupling with valve for water

F	A	B
1/2	61	35
3/4	61	35
1"	62,5	35

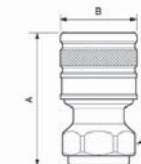
Codice 6412 Rubinetto rapido maschio con valvola per acqua
Male quick coupling with valve for water

F	A	B
1/2	76	35
3/4	76	35

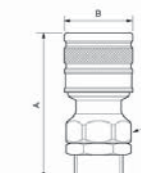
Codice 6413 Rubinetto rapido a resca con valvola per acqua
Hose coupling with valve for water

F	A	B
13	89	35
15/16	89	35
19	89	35

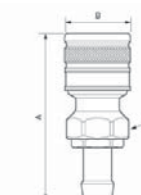
Codice 6415 Inneso rapido femmina con O-ring per acqua
Female quick connection with O-ring for water

F	A	B
1/2	42	30
3/4	42	30
1"	60	30

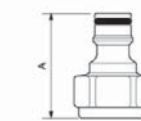
Codice 6416 Inneso rapido portagomma con O-ring per acqua
Rubber hose quick connection with O-ring for water

F	B	H
13	70	30
15	70	30
19	70	30

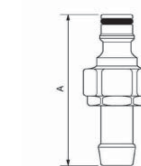
Codice 6418 Inneso rapido maschio con O-ring per acqua
Male quick connection with O-ring for water

F	B	H
1/2	57	30
3/4	57	30

