

RACCORDI AUTOMATICI INOX AISI 316 L STAINLESS STEEL PUSH-IN FITTINGS

DATI TECNICI

Materiale	acciaio inox 316 L e guarnizione FKM alimentare
Temperatura	min.-max. -15 °C +200 °C
Pressione min.	-0,99 bar
Pressione max.	15 bar
Fluidi compatibili	aria compressa, vuoto, e fluidi alimentari compatibili con i materiali costruttivi
Tubi di collegamento	poliammidi e PTFE
Filettature	gas conica ISO 7.1 gas cilindrica ISO 228

TECHNICAL SPECIFICATION

Materials	stainless steel and FKM seals
Temperature	min.-max -15 °C +220 °C
Min. pressure	-0,99 bar
Max. pressure	15 bar
Fluids	compressed air, vacuum and food stuffs compatible with the construction materials
Hoses	polyammydes and PTFE
Threads	tapered BSP ISO 7.1 parallel BSP ISO 228

I dati tecnici e le quote non sono vincolanti • Drawings and specifications are not binding

Raccordi automatici inox AISI 316 L • Stainless steel push-in fittings

Codice 8005

 Raccordo a L orientabile maschio conico inox 316
Stainless steel swivel elbow male adaptor (taper)

TUBO	A	B	L1	L2	⌀
4	1/8	7,5	18	17,5	11
6	1/8	7,5	21	19,5	11
8	1/8	7,5	22,5	20	11
6	1/4	11	21	23,5	14
8	1/4	11	22,5	24	14
10	1/4	11	26	25,5	17
10	3/8	11,5	26	27	17
12	3/8	11,5	30,5	30,5	18

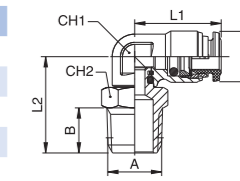
Codice 8015

 Raccordo a L intermedio inox 316
Stainless steel elbow connector

TUBO	C	L
4	10	18
6	12,5	21
8	14,5	22,5
10	17,5	26
12	20,5	30,5

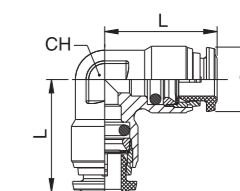
Codice 8020

 Raccordo a T orientabile maschio conico inox 316
Stainless steel swivel tee male adaptor

TUBO	A	B	L1	L2	⌀
4	1/8	7,5	36	18,5	11
6	1/8	7,5	42	19,5	11
8	1/8	7,5	45	20,5	11
6	1/4	11	42	23,5	14
8	1/4	11	45	24,5	14
10	1/4	11	52	26	14
10	3/8	11,5	52	27,5	17
12	3/8	11,5	61	30,5	18

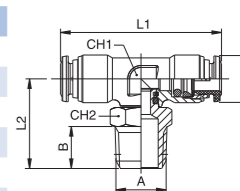
Codice 8025

 Raccordo a T intermedio inox 316
Stainless steel tee connector

TUBO	C	L1	L2
4	10	36	18
6	12,5	42	21
8	14,5	45	22,5
10	17,5	52	26
12	20,5	61	30,5

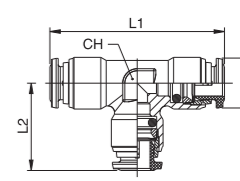
Codice 8000

 Raccordo diritto maschio conico inox 316
Stainless steel straight male adaptor (taper)

TUBO	A	B	L	⌀
4	1/8	7,5	19	10
6	1/8	7,5	22,5	13
8	1/8	7,5	25,5	14
6	1/4	11	24,5	14
8	1/4	11	25	14
10	1/4	11	30,5	17
10	3/8	11,5	28	17
12	3/8	11,5	33,5	21
12	1/2	14	32	22

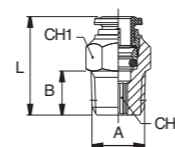
Codice 8010

 Raccordo diritto intermedio inox 316
Stainless steel straight connector

TUBO	L	B
4	31	10,5
6	35	12,5
8	36,5	14,5
10	42	17,5
12	48	20,5

