

## REGOLATORI DI FLUSSO FLOW REGULATORS

### DATI TECNICI

Materiale corpo	alluminio anodizzato e ottone
Temperatura	min.-max. -20 °C +80 °C
Pressione min.	1 bar
Pressione max.	10 bar
Fluidi	aria compressa
Tipo regolazione	a pomello
Filettatura	gas cilindrica ISO 228

### TECHNICAL SPECIFICATION

Body material	anodized aluminium and brass
Temperature	min.-max -20 °C +80 °C
Min. pressure	1 bar
Max. pressure	10 bar
Fluids	compressed air
Regulation	manual
Thread	parallel BSP ISO 228

I dati tecnici e le quote non sono vincolanti • Drawings and specifications are not binding



**Codice 7180** Regolatore di flusso unidirezionale  
Unidirectional flow regulator

A	B	C	D	F	M	⊕
1/8	35	22	24,7	4,5	M12x0,75	15
1/4	46	30	35	6,5	M12x0,75	15
3/8	50	30	35	6,5	M18x1,5	22
1/2	60	40	44	6,5	M18x1,5	22

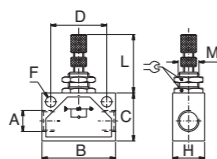

**Codice 7181** Regolatore di flusso bidirezionale  
Bidirectional flow regulator

A	B	C	D	F	M	⊕
1/8	35	22	24,7	4,5	M12x0,75	15
1/4	46	30	35	6,5	M12x0,75	15
3/8	50	30	35	6,5	M18x1,5	22
1/2	60	40	44	6,5	M18x1,5	22

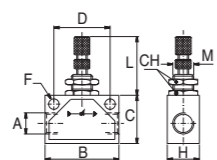

## SILENZIATORI SILENCERS

### DATI TECNICI

Fluidi	aria compressa
Temperatura	min.-max. -20 °C +80 °C
Pressione max.	10 bar
Filettatura	gas cilindrica ISO 228

### TECHNICAL SPECIFICATION

Fluids	compressed air
Temperature	min.-max -20 °C +80 °C
Max. pressure	10 bar
Thread	parallel BSP ISO 228

I dati tecnici e le quote non sono vincolanti • Drawings and specifications are not binding

**Codice 6830** Silenziatore con pastiglia in bronzo su base in ottone  
Sintered bronze silencer with brass hexagonal base

A	D	H	⊕
1/8	6	12	13
1/4	8	16	16
3/8	8	17	19
1/2	10	18	24
3/4	10	19	30
1"	10	20	36

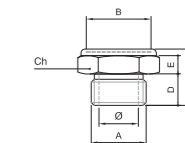

**Codice 6833** Silenziatore conico in bronzo su base in ottone  
Sintered bronze conical silencer with brass hexagonal base

A	D	H	E	⊕
1/8	6	26	4	13
1/4	8	34	5	16
3/8	8	41	5	19
1/2	10	46	6	24
3/4	10	56	6	30

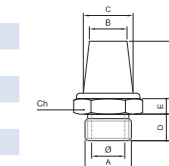

**Codice 6831** Silenziatore con testa esagonale in bronzo su base in acciaio ramato  
Sintered bronze silencer with hexagonal head and copper plated steel base

A	D	H	E	⊕
1/8	4,5	22,5	3	8
1/4	6	28	4	10
3/8	7	36	5	13
1/2	8	44	6	15
3/4	9	56	6	19
1"	11	69	7	24

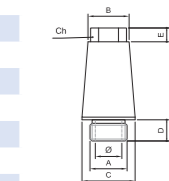

**Codice 6834** Silenziatore con regolazione di flusso  
Control valve with silencer

A	D	H max.	E	⊕
1/8	6	28	6,5	13
1/4	8	31	5,5	15
3/8	10	35	8	22
1/2	10	40	7,5	22

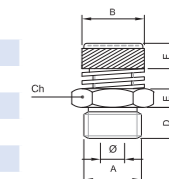

**Codice 6832** Silenziatore in plastica dinamica. Pressione max. 6 bar  
Plastic dynamic silencer. Max. pressure 6 bar

A	D	H	⊕
1/8	7	35	10
1/4	7	43	12
3/8	11	59	16
1/2	11	59	16
3/4	18	118	25
1"	18	118	25

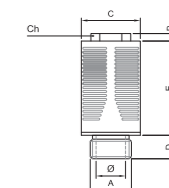

**Codice 6835** Silenziatore microforato su base esagonale inox 316  
Stainless steel silencer

A	D	H	E	⊕
1/8	8	15	4	14
1/4	8	15	4	17
3/8	10	18	5	22
1/2	12	18	7	27

