

VALVOLE A SFERA
BALL VALVES

DATI TECNICI

Materiale	ottone nichelato
Fluidi compatibili	aria, acqua e fluidi compatibili, compatibili con i materiali costruttivi
Guarnizioni sfera	PTFE
O-ring	NBR 70
Filettatura	cilindrica ISO 228
Temperatura	-10 °C - +120 °C
Direzione del flusso	bidirezionale

TECHNICAL SPECIFICATION

Materials	nickel plated brass
Fluids	compressed air, water and fluids compatible with construction materials
Seals for ball valve	PTFE
O-ring	NBR 70
Thread	parallel ISO 228
Temperature	-10 °C - +120 °C
Flow direction	bidirectional

DIAGRAMMA PRESSIONE UTILIZZO IN FUNZIONE DELLA TEMPERATURA

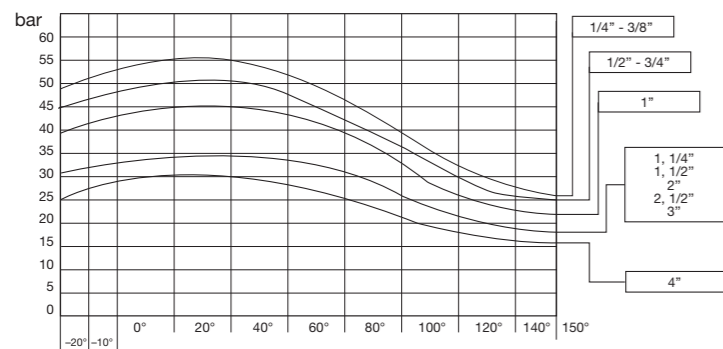

I dati tecnici e le quote non sono vincolanti • Drawings and specifications are not binding

 Codice
7085

 Valvola a sfera femmina passaggio totale
Full way ball valve F-F

A	B	D	L	⌀	DN
1/4	48	84	41,5	19	10
3/8	48	84	41,5	19	10
1/2	51	84	61	25	15
3/4	56	102	70	30	20
1"	58	102	81	37	25
1-1/4"	73	125	94	48	32
1-1/2"	78	125	105	54	40
2"	93	145	126	66	50

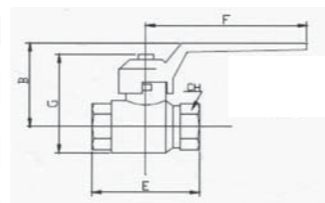
 Codice
7086

 Valvola a sfera maschio-femmina passaggio totale
Full way ball valve M-F

A	B	D	L	⌀	DN
1/4	48	84	51	19	10
3/8	48	84	51	19	10
1/2	51	84	69,5	25	15
3/4	56	102	77	30	20
1"	58	102	88	37	25
1-1/4"	73	125	104	48	32
1-1/2"	78	125	111	54	40
2"	93	145	133	66	50

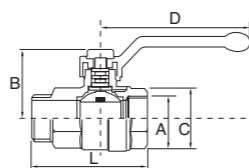
 Codice
7087

 Valvola a farfalla F-F passaggio totale
Full way ball valve F-F

A	B	D	L	⌀	DN
1/2	51	50	61	25	15
3/4	56	61	70	30	20

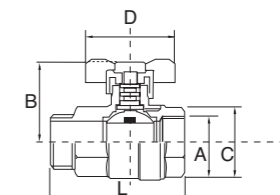
 Codice
7088

 Valvola a farfalla M-F passaggio totale
Full way ball valve M-F

A	B	D	L	⌀	DN
1/2	51	50	69,5	25	15
3/4	56	61	77	30	20

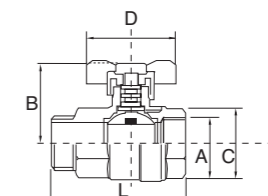
 Codice
7090

 Rubinetto di erogazione a sfera con portagomma
Ball cock with hose end

A	B	D	E	F	G	DN
1/2	45,5	14	105	63	94	10
3/4	48,5	20	119	63	106	12

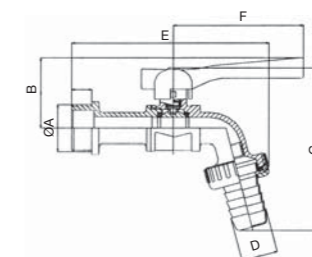
 A richiesta valvole speciali
per vapore e ossigeno

 Upon require special valves
for steam and oxygen