

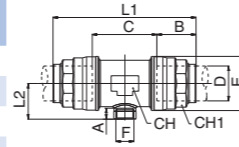

Codice 9060 Raccordo per calata femmina
Female fitting

Tubo mm. Tube mm.	F	A	L1	L2	↻
20	1/2	13,5	109	28	30
25	1/2	13,5	121,5	31	35
32	1/2	13,5	146,5	36,5	45
40	1/2	13,5	165,5	41,5	55
50	3/4	14,5	201	47,5	65



Codice 9045 Raccordo scarica condensa
Fitting with condense exhaust incorporated

Tubo mm. Tube mm.	L1	L2	↻ 1	↻ 2
20	52,5	67	32	30
25	57,5	72	32	35
32	67,5	82	38	45
40	77	91,5	50	55
50	86,5	101	55	65

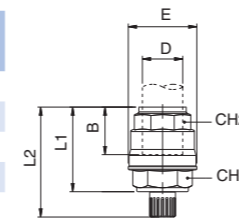

Codice 9035 Raccordo a staffa orientabile
Adjustable bracket fitting

Tubo mm. Tube mm.	F	L1	L2	L3	L max.	L min.	↻
20	1/2	35	51	35	40	22	30
25	3/4	37	62	39	40	22	35
32	1"	41	74,5	48,5	40	26	45

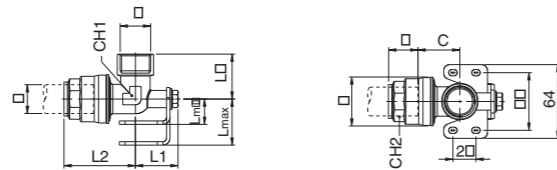

Codice 9040 Tappo
Plug



D	L	↻ 2
20	33	30
25	39	35
32	46,5	45
40	53	55
50	62	65

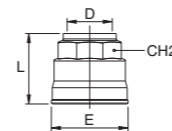

Codice 9071 Raccordo a L femmina
Elbow female connector

Tubo mm. Tube mm.	F	A	L	L1	↻
20	1/2	13	51	34,5	30
25	3/4	14,5	61,5	38,5	35
32	1"	16,5	74,5	47,5	45
40	1-1/4"	20	86,5	56,5	55
50	1-1/2"	22	104	64,7	65

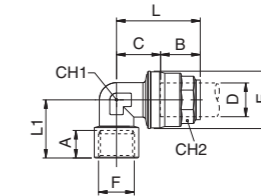

Codice 9025 Raccordo a T intermedio
Tee connector

Tubo mm. Tube mm.	L1	L2	↻
20	98	54,5	30
25	113,5	65	35
32	138,5	77	45
40	159,5	90	55
50	196	108	65

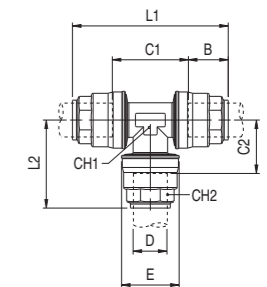

Codice 9030 Raccordo per calata
Tee connector

D1.	D2	L1	L2	↻ 1	↻ 2
20	20	109	54	30	30
25	20	121,5	59	35	30
32	20	146,5	63	45	30
32	25	146,5	70	45	35
40	20	165,5	66	55	30
40	25	165,5	73	55	35
50	20	201	73	65	30
50	25	201	80	65	35
50	32	201	87,5	65	45

